



INSTALLATION INSTRUCTIONS FOR PIPETEC MS / PPSU PRESS FITTINGS

The aluminium composite pipe is cut to the desired length using pipe cutters. The calibrator then ensures that the pipe end is completely round and deburred after cutting. At the same time the pipe interior is chamfered to allow the fitting to be inserted into the pipe without damaging the O-ring. Finally, the three openings (inspection windows) at the end of the stainless steel sleeve, which indicate the correct position of the pipe in the fitting, guarantee a correct pressing operation.

► NOTE

Perfect functioning of the pipe connection can only be ensured by using fittings with the DVGW-certified Pipetec aluminium multilayer composite pipe. Please note how important it is to ensure correct and expert calibration and deburring using a suitable tool. Always protect fittings with insulation or suitable adhesive tape to protect them from direct contact with concrete, screed, construction foam, mortar, etc. Make sure installation is stress-free! Brass threads that are sealed too tightly (especially when using hemp) can lead to stress corrosion cracking due to assembly.



1

CUTTING THE PIPE TO LENGTH

The pipe must be cut to the desired length using a suitable tool. The cross-sectional area of the cut must be perpendicular to the pipe. Diagonal cuts must be avoided.

Handsaws, jigsaws and blunt tools are not suitable for cutting to length.



2

CALIBRATING AND DEBURRING THE PIPE

The pipe end must be calibrated and deburred after trimming. To do this, the calibrator must first be inserted into the pipe up to the stop. Deburring is then completed by turning the calibrator. Turning removes material from the interior of the pipe, creating a chamfer on the end of the pipe. This chamfer makes it easier to insert the fitting and protects the O-rings from damage.



3

ASSEMBLY OF FITTINGS

Use appropriate force to insert the fitting into the end of the pipe axially up to the stop. The three inspection windows on the stainless steel pressing sleeve indicate the correct insertion depth. Please do not use additional lubricant.

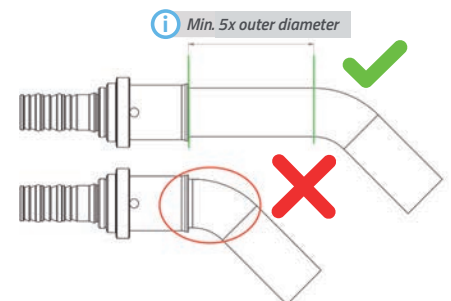

4

PRESSING

Using an appropriate pressing tool and pressing jaws that match the dimensions of the fitting, press until the pressing jaws are fully closed and the pressing process is complete. Then check the connection. It is essential to carry out a pressure and leak test (see page 94).

